

Agathon Stripper plate roller guide bushing

Standard 57.990.3xx



NEW

Bushing for backlash-free preloaded roller guide of the stripper plate

Guide bushing with flange without centering collar

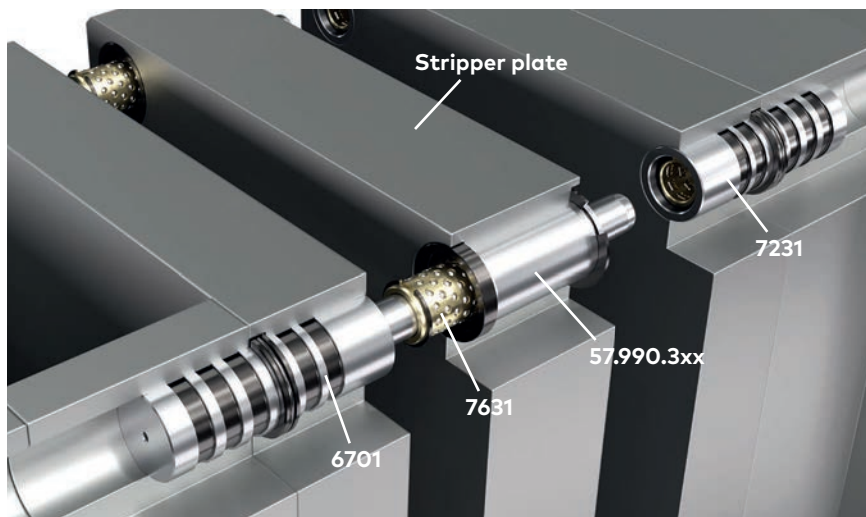

Advantages

- Backlash-free roller guide instead of sliding guide for maximum precision and lifespan
- Upgrade from sliding to roller guide at any time
- Perfect tribological conditions with pillar diameter tolerance h3
- Space-saving, minimum lubrication needed

Benefits

- Smooth rolling without plate flex = simplified tool handling
- Minimized offset
- Dimensionally compatible with and interchangeable with standard slide bushings

Features

- Tightest tolerances
- Shortest delivery times, anywhere in the world
- Integrated cage positioning
- Combined with standard ball or roller cages
- Simple fastening with circlip retainer

Technical data

- Material: 1.3505 (100Cr6)
- Hardness: 62+2HRC
- Outer diameter tolerance d3 = ISO h4
- Chamfer f8 as centering aid during assembly

Installation notes

- Press in guide bush only lightly – transition fit e.g. h4/JS4 is ideal
- Version for press-fitting on request
- With circlip retainer as fastening aid, installation space according to DIN 471/ d6
- Maximum stroke of stripper plate defined by length of recommended ball cage standard 7631. Maximum opening stroke see I5
- Longer strokes only after consultation with Agathon Application Technology

Applications

- Dynamic application – Guiding of a stripper plate
- Static application – Guiding of a heat channel plate during assembly
- Guidance of the ejector package

- d1 = Guide pillar, Tolerance h3/h4
- d2 = Bushing inner diameter
- d3 = Bushing outer diameter
- d4 = Installation space for circlip retainer DIN 471
- d5 = Flange diameter
- d6 = Installation space for fastening element
- l1 = Bushing length
- l2 = Cage length, $l2 < l1$
- l3 = Flange width
- l4 = Installation position of the fastening element
- l5 = Max. opening length of the stripper plate
- l6 = Diameter length (suitable for l3 according to standard 7631)
- lx = Bushing inlet (2 mm)

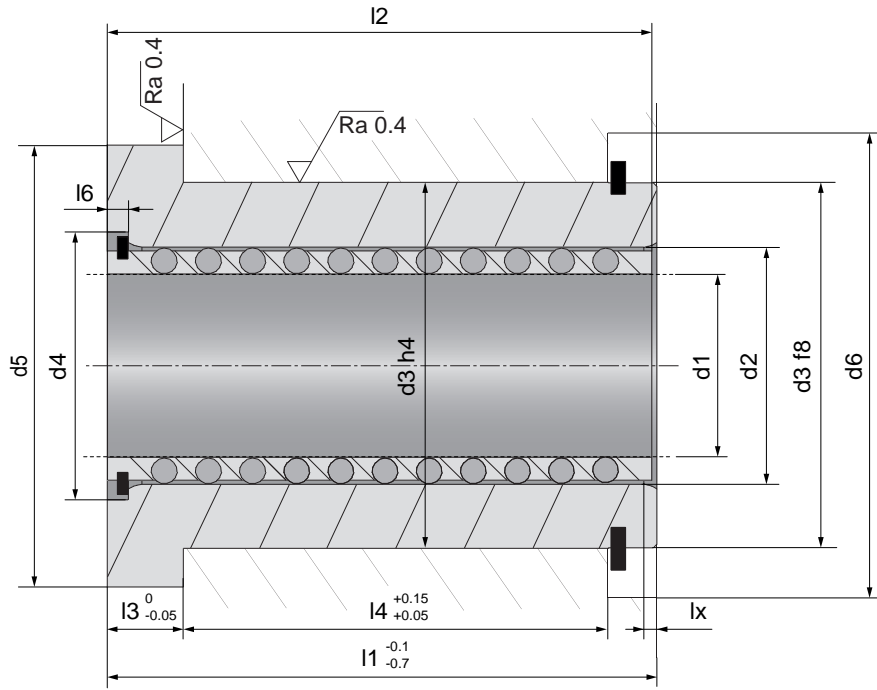
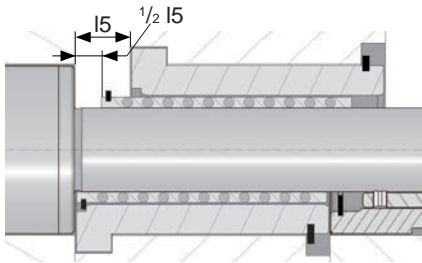

Article	d1	d2	d3	d4	d5	d6	l1	l2	l3	l4	l5 _{max} HUB	l6	Recom. ball cage Standard 7631
57.990.300	15	21	30	29	35	42	27	24	6	16	18	3.5	7631.015.024
57.990.301	15	21	30	29	35	42	36	35	6	25	29	3.5	7631.015.035
57.990.302	15	21	30	29	35	42	46	42	6	35	36	3.5	7631.015.042
57.990.303	15	21	30	29	35	42	56	52	6	45	46	3.5	7631.015.052
57.990.354	15	21	30	29	35	42	66	65	6	55	59	3.5	7631.015.065
57.990.307	25	31	42	40.5	47	56	27	-	6	14	-	3.8	on request
57.990.308	25	31	42	40.5	47	56	36	-	6	23	-	3.8	on request
57.990.309	25	31	42	40.5	47	56	46	43	6	33	37	3.8	7631.025.043
57.990.310	25	31	42	40.5	47	56	56	52	6	43	46	3.8	7631.025.052
57.990.311	25	31	42	40.5	47	56	66	60	6	53	54	3.8	7631.025.060
57.990.355	25	31	42	40.5	47	56	76	67	6	63	61	3.8	7631.025.067
57.990.319	32	40	54	50	59	72	36	-	10	18	-	4.5	on request
57.990.320	32	40	54	50	59	72	46	-	10	28	-	4.5	on request
57.990.321	32	40	54	50	59	72	56	52	10	38	45	4.5	7631.032.052
57.990.322	32	40	54	50	59	72	66	65	10	48	58	4.5	7631.032.065
57.990.356	32	40	54	50	59	72	76	74	10	58	67	4.5	7631.032.074
57.990.336	40	48	66	59.5	71	84	36	-	10	18	-	4.5	on request
57.990.337	40	48	66	59.5	71	84	46	-	10	28	-	4.5	on request
57.990.338	40	48	66	59.5	71	84	56	-	10	38	-	4.5	on request
57.990.339	40	48	66	59.5	71	84	66	65	10	48	58	4.5	7631.040.065
57.990.357	40	48	66	59.5	71	84	76	75	10	58	68	4.5	7631.040.075

Bold = from stock *Italic = 5 to 10 days delivery time*

